

LAFCO APPLICATION NO. 2022-04
 NEWMAN DETACHMENT OF TERRITORY FROM THE
 CENTRAL CALIFORNIA IRRIGATION DISTRICT
 PROJECT MAP

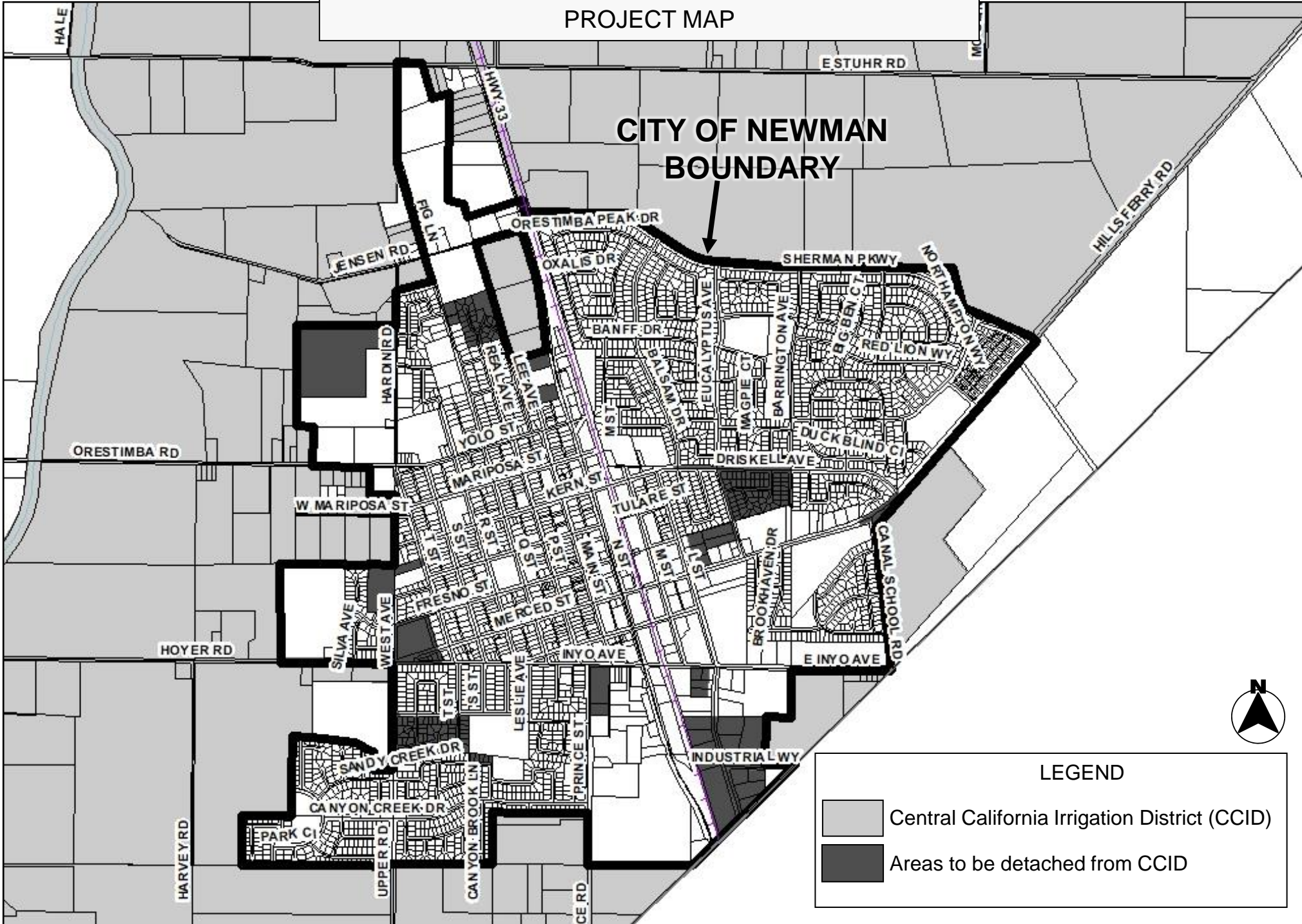

**CITY OF NEWMAN
 BOUNDARY**

LEGEND

- Central California Irrigation District (CCID)
- Areas to be detached from CCID

Northwest Newman:
West of 33 & North of Mariposa St.
For Illustrative Purposes Only



Southwest Newman:
West of 33 & North of Mariposa St.
For Illustrative Purposes Only

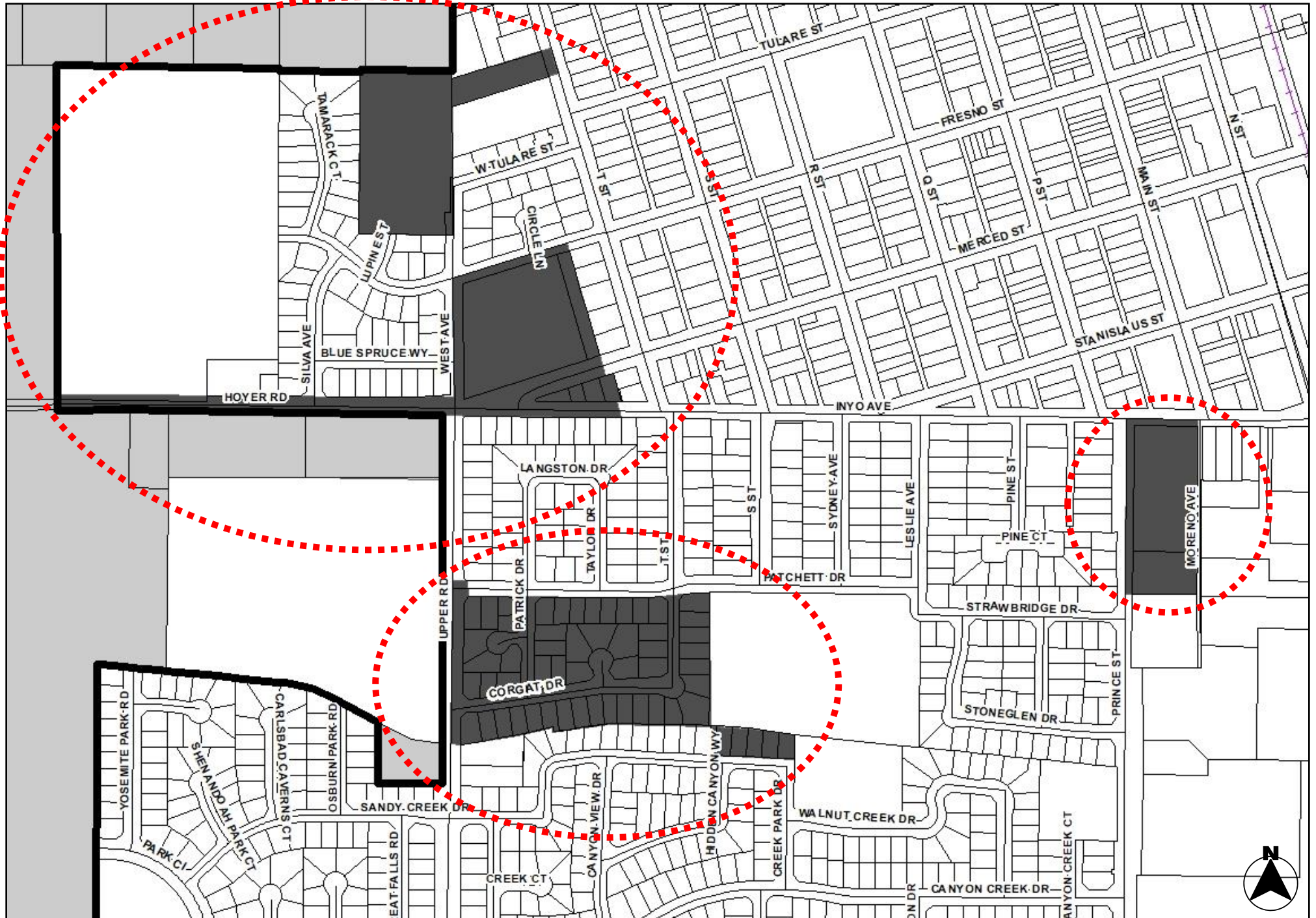

East Newman:
East of 33 & North of Merced St. & Hills Ferry Rd.
For Illustrative Purposes Only

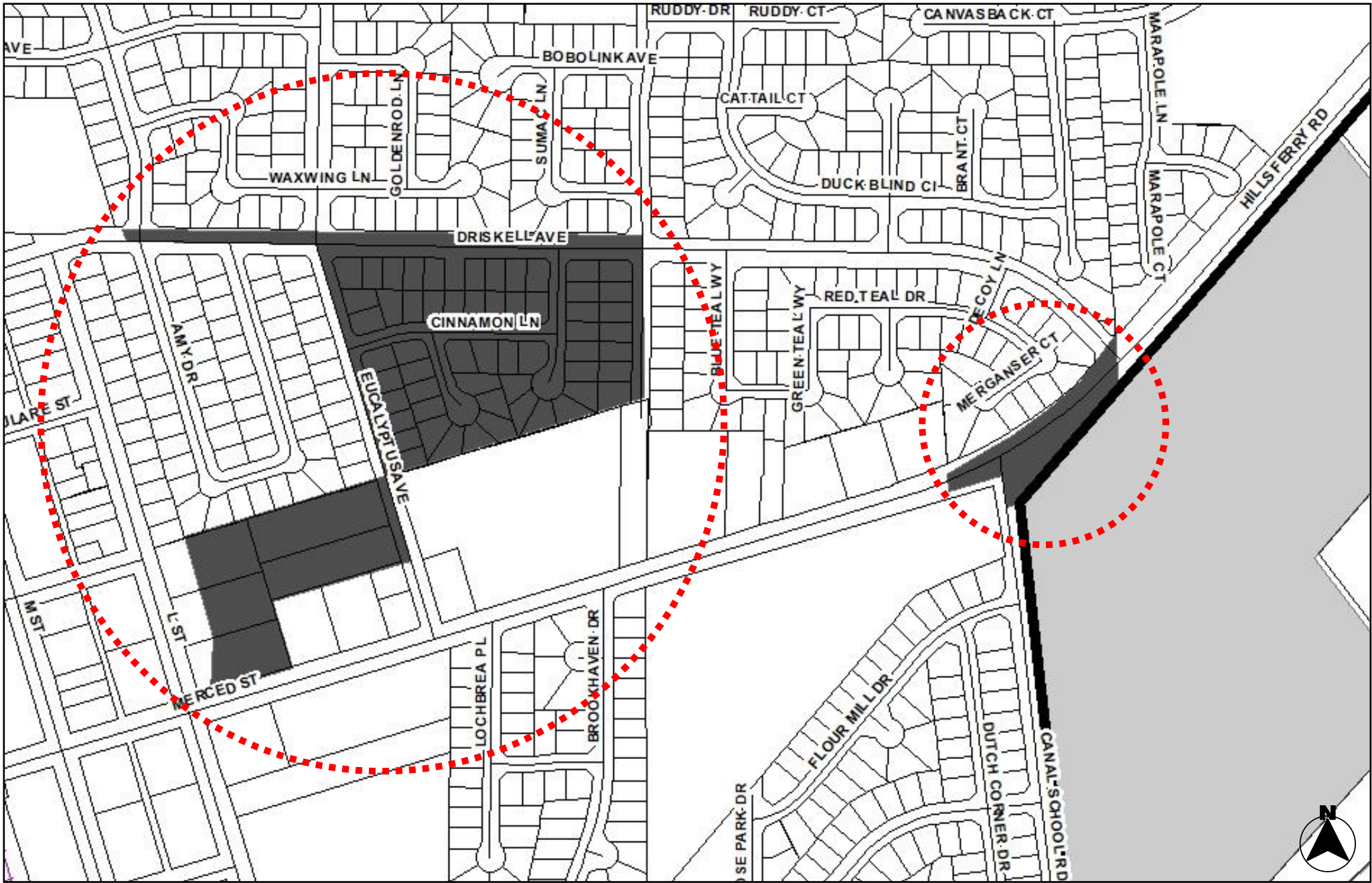

Southeast Newman:
East of 33 & South of Inyo Ave.
For Illustrative Purposes Only

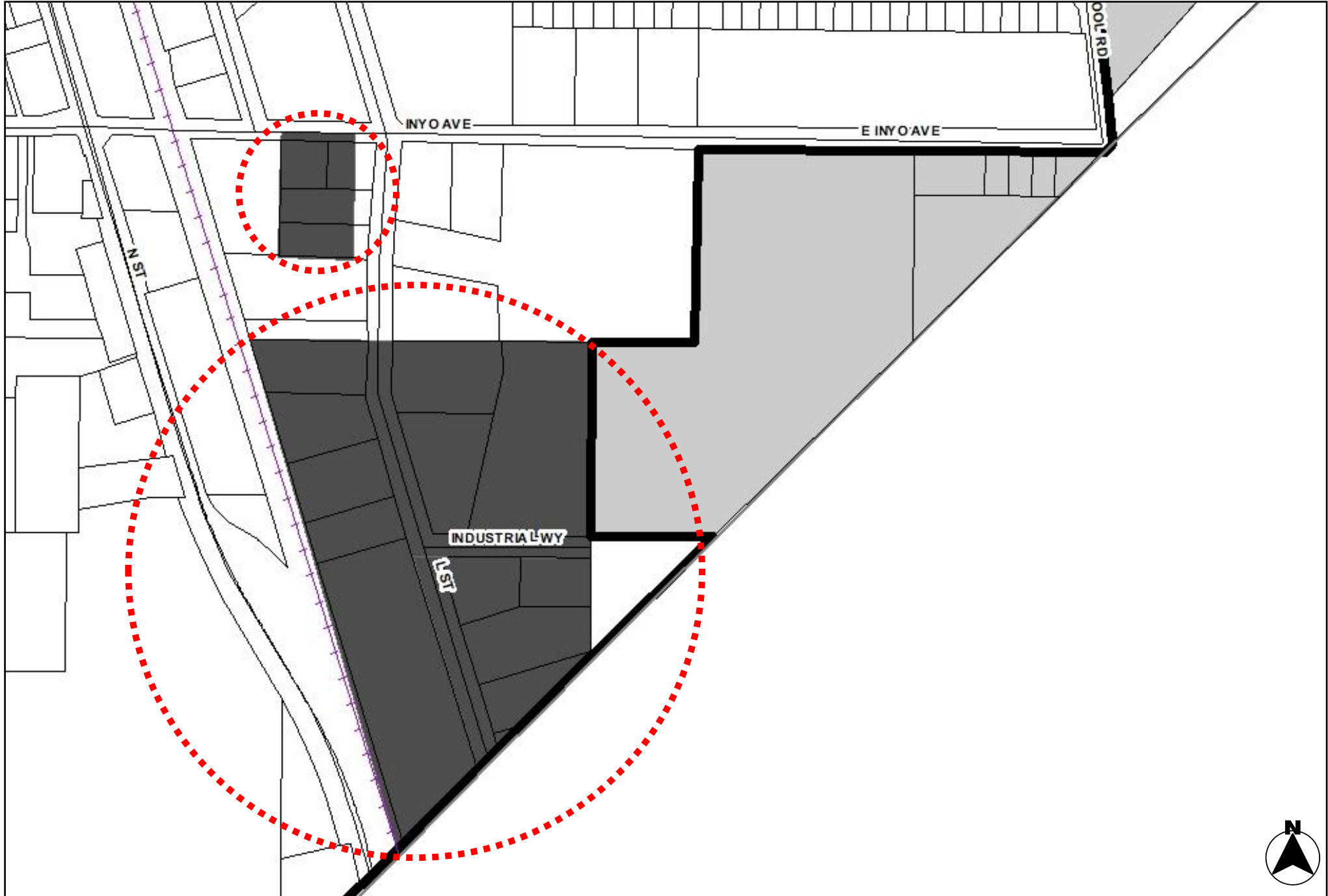

NEWMAN DETACHMENT OF TERRITORY FROM THE
CENTRAL CALIFORNIA IRRIGATION DISTRICT (CCID)

DESCRIPTION

All that territory located within the Central California Irrigation District (CCID) boundaries that overlaps the current City Limits of the City of Newman.

Containing an area of approximately 118 acres.